

Technical Information

Honeywell Connected Plant
Collaboration Station Specification



EP03-220-510

Release 510

6 July 2018, 1.0

Revision History

Revision	Date	Description
1	6 th July 2018	Release version

Table of Contents

1. Introduction 4

1.1. Collaboration Station 4

1.2. Deployment Locations 4

1.2.1. Use on the Process Control Network (PCN)4

1.2.2. Use on the Business Network (L4)5

2. Collaboration Station Specifications..... 6

2.1. Configuration Limits 6

2.2. Qualified applications 7

2.3. Experion Compatibility Considerations 8

2.3.1. Experion Releases8

2.3.2. DSA Considerations8

2.3.3. Experion Content8

3. Experion Collaboration Station Hardware and Sizing Requirements 9

3.1. Experion Collaboration Station Sizing 9

3.2. Experion Collaboration Station Computer Hardware Requirements..... 9

3.3. Experion Collaboration Station Screen Requirements.....10

4. Model Number.....10

5. Glossary.....10

1. Introduction

1.1. Collaboration Station

Honeywell Collaboration Station is the hub of digital transformation for industrial process industries, providing a unified visualization architecture for turning data into actionable insight, from edge to enterprise, to help customers improve their bottom line. Drive better decision making by unlocking the full value of information and applications through organization, methodology and deep linking in an easy to use collaborative environment. From the control room to the boardroom, Collaboration Station drives culture change and breaks down silos across roles and geographies by integrating enterprise wide data from business, process, assets and people.

1.2. Deployment Locations

Collaboration Station supports use on both the Process Control Network and the Business Network.

1.2.1. Use on the Process Control Network (PCN)

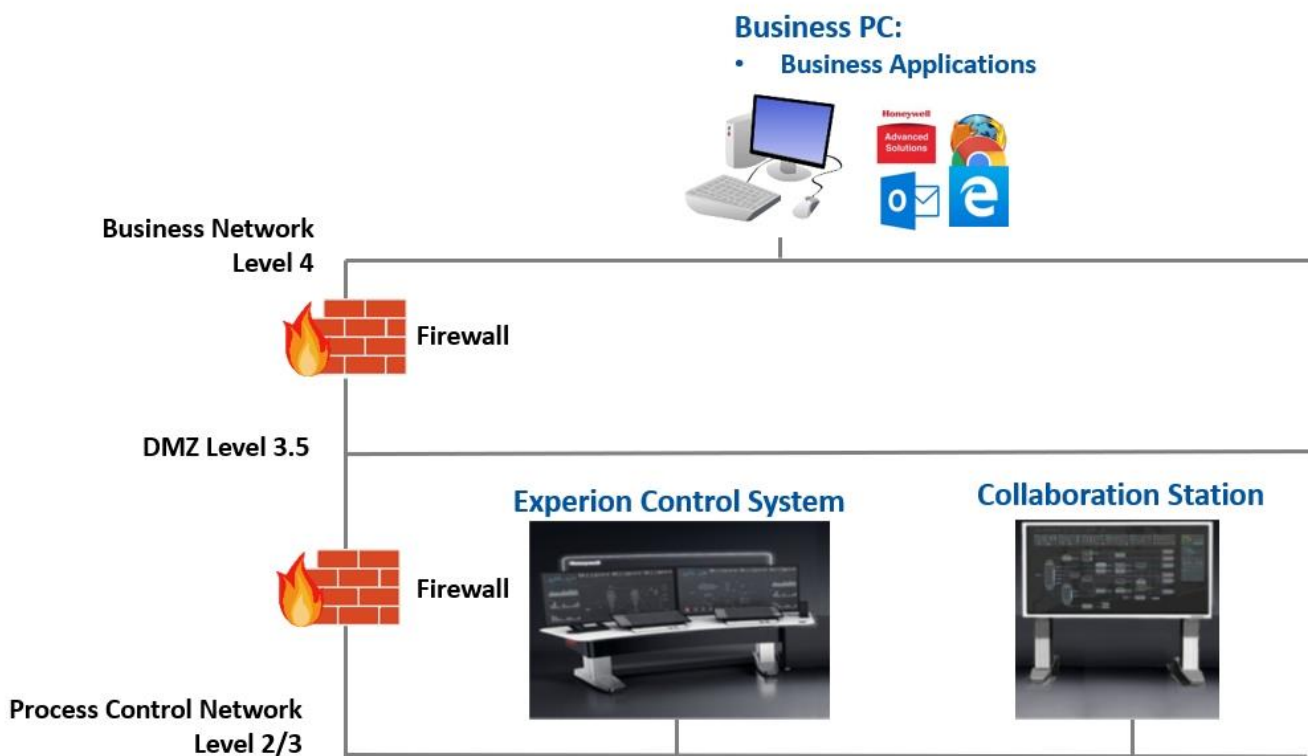

Figure 1 : Process Control Network Topology

On the Process Control Network (PCN) Collaboration Station connects directly to an Experion Server. This minimizes and simplifies the required engineering and has the following functional benefits:

- Higher performance and capacity (see Configuration Limits)
- Experion Server redundancy
- Experion display file replication

Collaboration Station access to applications on the business network can be achieved using Microsoft Remote Desktop. Skype integration is disabled when Collaboration Station is used on the PCN.

1.2.2. Use on the Business Network (L4)

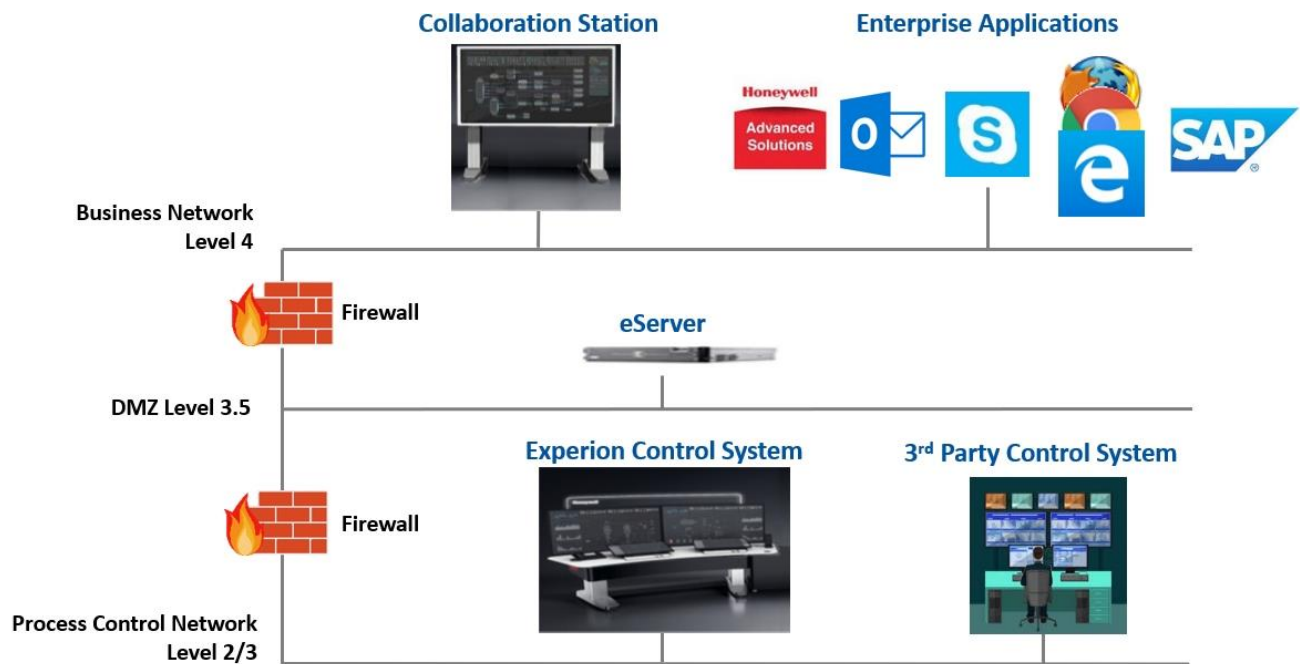

Figure 2: Business Network Topology

When used on the business network, Collaboration Station supports direct use of business/enterprise applications, including integration of Skype communication. For use on the business network the following are required:

- Experion eServer
- Collaboration Station specific network and operating system policies. Customer IT acceptance for these policies on Collaboration Station nodes is required.

2. Collaboration Station Specifications

2.1. Configuration Limits

Description	Connected to eServer	Connected to Experion server
Max number of Collaboration Stations	4	7 ¹
Maximum number of radial menus per workspace. Each of which may have an aggregated alarm icon.	50	100
Maximum number of parameters per workspace	400	700 (max 350 on Flex Server)
Number of parameters per second (pps) per Collaboration Station	700	1,000/sec
Number of dynamic parameters per Collaboration Station ³	2000	3000
Maximum number of items per Radial Menu Petal	10	10
Maximum number of background bitmaps per workspace ⁴	5	5
Maximum number of alarm icons per workspace ⁵	50	Limited only by max number of parameters per workspace
Maximum number of zoom regions per workspace	50	100
Maximum number of open schematics per Collaboration Station	40	40
Maximum number of live updated schematics per Collaboration Station	10	10
Maximum number of open applications per Collaboration Station ⁶	20	20
<p>Note 1: For an Experion server the maximum number of Stations (including Collaboration Stations) is dependent on the Experion Server Platform. For Standard Server hardware the max limit is 30, for Performance Server hardware the max limit is up to 40. The total of all Stations (including Collaboration Stations) cannot exceed this limit for the Experion server. Also, the number of Stations that can be supported may be limited by the Experion Server data access performance (parameter per second that can be supplied by the server).</p> <p>Note 2: When more than 1,000 dynamic parameters are configured, the update rate must be greater than 1 sec. to not violate max pps Ability to deliver published data rate depends upon throughput of underlying process control network. For example, for a heavily loaded EST system there may not be sufficient LCN bandwidth to deliver 3000 parameters. Refer to the documentation associated with the process control network for more information</p> <p>Note 3: Based on bitmap resolution of 3840x2160</p> <p>Note 4: This includes alarm icons that appear as part of radial menus</p> <p>Note 5: Examples of applications are Word or Excel. Experion schematics have separate limits as shown</p>		

2.2. Qualified applications

Collaboration Station supports both 32bit and 64bit applications. The following applications have been tested and qualified for use in Experion Collaboration Station. All other applications should be tested with Collaboration Station prior to use to ensure compatibility with Collaboration Station and the touch screen.

Items	Qualification	Comments
Experion HMIWeb Displays	Supported	Read only access to Experion HMIWeb displays is supported.
Office applications: Microsoft Excel, Word, PowerPoint, Adobe PDF	Supported	
Honeywell Advanced Solutions: Uniformance Executive and Asset Sentinel	Supported	
Business applications	Supported	32bit and 64bit applications are supported for use directly in Collaboration Station. Any application not listed in this table should be installed and tested prior to use to ensure compatibility with Collaboration Station and the touch screen.
Web pages and Web applications	Supported	Collaboration Station's inbuilt web browser is used by default to open web pages however Internet Explorer, Chrome or Mozilla can also be used.
Applications on remote computers accessed via integrated Microsoft RemoteApp or Remote Desktop	Supported	Not required when using Collaboration Station on the business network. The applications can be installed and used in Collaboration Station directly
Skype	L4 Support Only	Skype is disabled by default in R510. It can be enabled for Business Network (L4) use only.
Honeywell cannot take responsibility for issues resulting from the installation or use of any software that has not been tested for Experion compatibility by Honeywell. Ensure sufficient system resources such as memory, CPU performance, disk space, display space, and so on are available on the Collaboration Station Workstation.		

2.3. Experion Compatibility Considerations

2.3.1. Experion Releases

As per standard distributed system architecture (DSA) Interoperability guidelines, the Experion eServer and associated Collaboration Station can obtain data and alarms from Experion Servers of the following releases:

Supported DSA connected Experion Server Releases
R510
R501, R500
R43x
R41x

2.3.2. DSA Considerations

The standard requirements for configuring DSA between the Experion Server (or eServer), that Collaboration Station is connected to, and other Process Servers must be considered. These include:

- Network connectivity –
 - **Collaboration Station on the PCN:** Experion Collaboration Station shall reside on the PCN Level 2/3 and directly connect to a corresponding Experion Server. The Experion Server must have a DSA connection to all other desired Experion Servers on the PCN.
 - **Collaboration Station on the Business Network:** When Experion Collaboration Station resides on the Business Network (Level 4) it must be connected to an Experion eServer located on the DMZ (Level 3.5). **The eServer must have direct DSA connection to all required the Experion Servers on Level 2 and 3.**
 - Point item name uniqueness - For points that are not assets, full item names must be unique across all servers.
 - Display names must be unique across all servers.
- See the “Requirements for implementing a DSA system” section of the “Server and Client Configuration Guide”.

2.3.3. Experion Content

Items	Specification Connected to eServer	Specification Connected to Experion server
Alarms and Event information	Supported	Supported
Experion Trends	Supported ¹	Supported
System displays including groups, detail displays and faceplates	Supported	Supported
Embedded CDA charts	Not supported	Not supported
Pan and Zoom displays	Supported	Supported
Integrated Digital Video Manager	Not supported	Supported ²

Note 1: Maximum of 100 Trend pens that Collaboration Station can view when connected to eServer to from all remote servers.

Note 2: DVM objects within HMIWeb displays and system displays is supported. DVM web client camera view is supported.

3. Collaboration Station Hardware and Sizing Requirements

3.1. Collaboration Station Sizing

The computer used for Collaboration Station must be the performance workstation as used for other Experion stations. Memory must be expanded to the maximum. These guidelines are intended to provide a minimum baseline. Honeywell computer platforms meet these specifications but may not necessarily be the example platforms listed below. Honeywell computers carry full support as a qualified offering.

3.2. Collaboration Station Computer Hardware Requirements

Example specification:

System Configuration	Performance
Processor	Intel® 3.50GHz, 4 core or greater
RAM	8 GB
Networking	100 Mbps Ethernet
Video resolution	3840x2160 (4K), 65K or higher colors
Example video card model number:	MZ-QUAD06 NVS510
Operating system	Microsoft Windows 10 IoT Enterprise LTSC x64
Hard Drive	500 GB
Browser type	Microsoft Internet Explorer 11
Honeywell Computer Platforms examples ¹	MZ-PCWS92 (Dell T5810XL Performance Tower) MZ-PCWS82 (HP Z440 Performance Tower) MZ-PCWS76 (Dell R7910XL Performance Rack 2U) Note: The MZ-QUAD06 NVS510 video card is required in addition to the base PC to ensure 4K screen support
Note 1 – For further information on Honeywell computer platforms, see their respective specifications.	

3.3. Collaboration Station Screen Requirements

The Collaboration Station screen is provided separately as a third-party item.

System Configuration	Specification
Operating System support	Windows 10
Screen Definition	UHD (4K)
Multi Touch Support	2 point or greater with gesture control
Sound	Audio support
Size minimum	60 "
Size maximum	86"
Qualified UHD Touch screens ¹	LG UHD Commercial grade touch monitors: <ul style="list-style-type: none"> • LG86TR3D – 86" (20-Point Multi-Touch) • LG75TC3D – 75" (40-Point Multi-Touch)
Note 1 – Honeywell shall not take responsibility for issues found with use of unqualified touch monitors.	

4. Model Number

Model Number	Description
EP-STACSN	Collaboration Station (1 connection)

5. Glossary

Term or Acronym	Description
DSA	Distributed System Architecture
EMDB	Enterprise Model Database. The Experion Enterprise Model provides an intuitive way to manage the Experion system.
Experion Server	The node (optionally redundant) at the heart of Experion. The servers encompass a wide range of subsystems including history collection, SCADA interfaces, alarm/event, etc.

Experion® is a registered trademark of Honeywell International Inc.

All other products and brand names shown are trademarks of their respective owners.

This document contains Honeywell proprietary information. It is published for the sole usage of Honeywell Process Solutions' customers and prospective customers worldwide. Information contained herein is to be used solely for the purpose submitted, and no part of this document or its contents shall be reproduced, published, or disclosed to a third party without the express permission of Honeywell International Inc.

While this information is presented in good faith and believed to be accurate, Honeywell disclaims the implied warranties of merchantability and fitness for a particular purpose and makes no express warranties except as may be stated in its written agreement with and for its customer.

In no event is Honeywell liable to anyone for any indirect, special or consequential damages. The information and specifications in this document are subject to change without notice.

For more information

To learn more about Honeywell's products or solutions visit our website www.honeywellprocess.com or contact your Honeywell account manager.

Automation & Control Solutions

Process Solutions
Honeywell

1250 West Sam Houston Parkway South
Houston, TX 77042

Honeywell House, Arlington Business Park,
Bracknell, Berkshire, England RG12 1EB UK

Shanghai City Centre, 100 Junyi Road
Shanghai, China 20051

www.honeywellprocess.com

EP03-220-510
6 July 2018
© 2015 Honeywell International Inc.

The Honeywell logo, consisting of the word "Honeywell" in a bold, red, sans-serif font.